

Paid £190



Lancaster
Application for a premises licence
Licensing Act 2003

For help contact
licensing@lancaster.gov.uk
Telephone: 01524 582033

* required information

Section 1 of 21

You can save the form at any time and resume it later. You do not need to be logged in when you resume.

System reference

Not Currently In Use

This is the unique reference for this application generated by the system.

Your reference

AF/ALC65

You can put what you want here to help you track applications if you make lots of them. It is passed to the authority.

Are you an agent acting on behalf of the applicant?

Yes No

Put "no" if you are applying on your own behalf or on behalf of a business you own or work for.

Applicant Details

* First name

Ranjit Kaur

* Family name

Uppal

* E-mail

andrea@forrestsolicitors.co.uk

Main telephone number

Include country code.

Other telephone number

Indicate here if the applicant would prefer not to be contacted by telephone

Is the applicant:

- Applying as a business or organisation, including as a sole trader
 Applying as an individual

A sole trader is a business owned by one person without any special legal structure. Applying as an individual means the applicant is applying so the applicant can be employed, or for some other personal reason, such as following a hobby.

Applicant Business

Is the applicant's business registered in the UK with Companies House?

Yes No

Note: completing the Applicant Business section is optional in this form.

Registration number

07216379

Business name

Lifestyle express stores limited

If the applicant's business is registered, use its registered name.

VAT number

-

Put "none" if the applicant is not registered for VAT.

Legal status

Private Limited Company

Continued from previous page...

Applicant's position in the business

Home country

The country where the applicant's headquarters are.

Registered Address

Address registered with Companies House.

Building number or name

Street

District

City or town

County or administrative area

Postcode

Country

Agent Details

* First name

* Family name

* E-mail

Main telephone number

Include country code.

Other telephone number

Indicate here if you would prefer not to be contacted by telephone

Are you:

An agent that is a business or organisation, including a sole trader

A sole trader is a business owned by one person without any special legal structure.

A private individual acting as an agent

Agent Business

Is your business registered in the UK with Companies House? Yes No

Note: completing the Applicant Business section is optional in this form.

Is your business registered outside the UK? Yes No

Business name

If your business is registered, use its registered name.

VAT number

Put "none" if you are not registered for VAT.

Legal status

Continued from previous page...

Your position in the business

Home country

The country where the headquarters of your business is located.

Agent Business Address

If you have one, this should be your official address - that is an address required of you by law for receiving communications.

Building number or name

Street

District

City or town

County or administrative area

Postcode

Country

Section 2 of 21

PREMISES DETAILS

I/we, as named in section 1, apply for a premises licence under section 17 of the Licensing Act 2003 for the premises described in section 2 below (the premises) and I/we are making this application to you as the relevant licensing authority in accordance with section 12 of the Licensing Act 2003.

Premises Address

Are you able to provide a postal address, OS map reference or description of the premises?

- Address OS map reference Description

Postal Address Of Premises

Building number or name

Street

District

City or town

County or administrative area

Postcode

Country

Further Details

Telephone number

Non-domestic rateable value of premises (£)

Section 3 of 21

APPLICATION DETAILS

In what capacity are you applying for the premises licence?

- An individual or individuals
- A limited company / limited liability partnership
- A partnership (other than limited liability)
- An unincorporated association
- Other (for example a statutory corporation)
- A recognised club
- A charity
- The proprietor of an educational establishment
- A health service body
- A person who is registered under part 2 of the Care Standards Act 2000 (c14) in respect of an Independent hospital in Wales
- A person who is registered under Chapter 2 of Part 1 of the Health and Social Care Act 2008 in respect of the carrying on of a regulated activity (within the meaning of that Part) in an independent hospital in England
- The chief officer of police of a police force in England and Wales

Confirm The Following

- I am carrying on or proposing to carry on a business which involves the use of the premises for licensable activities
- I am making the application pursuant to a statutory function
- I am making the application pursuant to a function discharged by virtue of Her Majesty's prerogative

Section 4 of 21

NON INDIVIDUAL APPLICANTS

Provide name and registered address of applicant in full. Where appropriate give any registered number. In the case of a partnership or other joint venture (other than a body corporate), give the name and address of each party concerned.

Non Individual Applicant's Name

Name

Details

Registered number (where applicable)

Description of applicant (for example partnership, company, unincorporated association etc)

Continued from previous page...

Limited Company

Address

Building number or name	219
Street	Elmers Green Lane
District	Skelmersdale
City or town	
County or administrative area	Merseyside
Postcode	WN8 6SJ
Country	United Kingdom

Contact Details

E-mail	
Telephone number	
Other telephone number	
* Date of birth	<input type="text"/> / <input type="text"/> / <input type="text"/> dd mm yyyy

* Nationality Documents that demonstrate entitlement to work in the UK

Section 5 of 21

OPERATING SCHEDULE

When do you want the premises licence to start? / /
dd mm yyyy

If you wish the licence to be valid only for a limited period, when do you want it to end / /
dd mm yyyy

Provide a general description of the premises

For example the type of premises, its general situation and layout and any other information which could be relevant to the licensing objectives. Where your application includes off-supplies of alcohol and you intend to provide a place for consumption of these off-supplies you must include a description of where the place will be and its proximity to the premises.

Food take-away
on-line alcohol sales only with food delivery orders - not on site

Continued from previous page...

If 5,000 or more people are expected to attend the premises at any one time, state the number expected to attend

Section 6 of 21

PROVISION OF PLAYS

See guidance on regulated entertainment

Will you be providing plays?

Yes

No

Section 7 of 21

PROVISION OF FILMS

See guidance on regulated entertainment

Will you be providing films?

Yes

No

Section 8 of 21

PROVISION OF INDOOR SPORTING EVENTS

See guidance on regulated entertainment

Will you be providing indoor sporting events?

Yes

No

Section 9 of 21

PROVISION OF BOXING OR WRESTLING ENTERTAINMENTS

See guidance on regulated entertainment

Will you be providing boxing or wrestling entertainments?

Yes

No

Section 10 of 21

PROVISION OF LIVE MUSIC

See guidance on regulated entertainment

Will you be providing live music?

Yes

No

Section 11 of 21

PROVISION OF RECORDED MUSIC

See guidance on regulated entertainment

Will you be providing recorded music?

Yes

No

Section 12 of 21

PROVISION OF PERFORMANCES OF DANCE

See guidance on regulated entertainment

Will you be providing performances of dance?

Continued from previous page...

Section 13 of 21

PROVISION OF ANYTHING OF A SIMILAR DESCRIPTION TO LIVE MUSIC, RECORDED MUSIC OR PERFORMANCES OF DANCE

See guidance on regulated entertainment

Will you be providing anything similar to live music, recorded music or performances of dance?

Yes No

Section 14 of 21

LATE NIGHT REFRESHMENT

Will you be providing late night refreshment?

Yes No

Standard Days And Timings

MONDAY

Start 23:00

End 03:00

Start

End

Give timings in 24 hour clock.
(e.g., 16:00) and only give details for the days
of the week when you intend the premises
to be used for the activity.

TUESDAY

Start 23:00

End 03:00

Start

End

WEDNESDAY

Start 23:00

End 03:00

Start

End

THURSDAY

Start 23:00

End 03:00

Start

End

FRIDAY

Start 23:00

End 03:00

Start

End

SATURDAY

Start 23:00

End 03:00

Start

End

SUNDAY

Start 23:00

End 03:00

Start

End

Continued from previous page...

Will the provision of late night refreshment take place indoors or outdoors or both?

- Indoors Outdoors Both

Where taking place in a building or other structure tick as appropriate. Indoors may include a tent.

State type of activity to be authorised, if not already stated, and give relevant further details, for example (but not exclusively) whether or not music will be amplified or unamplified.

Take Away food on the premises
On-line takeaway delivery orders with alcohol

State any seasonal variations

For example (but not exclusively) where the activity will occur on additional days during the summer months.

One additional hour to standard timings on the day that British Summer Time Commences

Non-standard timings. Where the premises will be used for the supply of late night refreshments at different times from those listed in the column on the left, list below

For example (but not exclusively), where you wish the activity to go on longer on a particular day e.g. Christmas Eve.

Section 15 of 21

SUPPLY OF ALCOHOL

Will you be selling or supplying alcohol?

- Yes No

Standard Days And Timings

MONDAY

Start

End

Start

End

TUESDAY

Start

End

Start

End

Give timings in 24 hour clock.
(e.g., 16:00) and only give details for the days
of the week when you intend the premises
to be used for the activity.

Continued from previous page...

WEDNESDAY

Start End

Start End

THURSDAY

Start End

Start End

FRIDAY

Start End

Start End

SATURDAY

Start End

Start End

SUNDAY

Start End

Start End

Will the sale of alcohol be for consumption:

- On the premises Off the premises Both

If the sale of alcohol is for consumption on the premises select on, if the sale of alcohol is for consumption away from the premises select off. If the sale of alcohol is for consumption on the premises and away from the premises select both.

State any seasonal variations

For example (but not exclusively) where the activity will occur on additional days during the summer months.

Alcohol will be supplied ancillary to a food order delivery only
Alcohol will not be on display on the premises for sale

Non-standard timings. Where the premises will be used for the supply of alcohol at different times from those listed in the column on the left, list below

For example (but not exclusively), where you wish the activity to go on longer on a particular day e.g. Christmas Eve.

One additional hour to standard timings on the day that British Summer Time Commences

State the name and details of the individual whom you wish to specify on the licence as premises supervisor

Continued from previous page...

Name

First name

Family name

Date of birth / /
dd mm yyyy

Enter the contact's address

Building number or name

Street

District

City or town

County or administrative area

Postcode

Country

Personal Licence number (if known)

Issuing licensing authority (if known)

PROPOSED DESIGNATED PREMISES SUPERVISOR CONSENT

How will the consent form of the proposed designated premises supervisor be supplied to the authority?

- Electronically, by the proposed designated premises supervisor
- As an attachment to this application

Reference number for consent form (if known)

If the consent form is already submitted, ask the proposed designated premises supervisor for its 'system reference' or 'your reference'.

Section 16 of 21

ADULT ENTERTAINMENT

Highlight any adult entertainment or services, activities, or other entertainment or matters ancillary to the use of the premises that may give rise to concern in respect of children

Give information about anything intended to occur at the premises or ancillary to the use of the premises which may give rise to concern in respect of children, regardless of whether you intend children to have access to the premises, for example (but not exclusively) nudity or semi-nudity, films for restricted age groups etc gambling machines etc.

None

Continued from previous page...

Section 17 of 21

HOURS PREMISES ARE OPEN TO THE PUBLIC

Standard Days And Timings

MONDAY

Start 08:00

End 03:30

Start

End

Give timings in 24 hour clock.
(e.g., 16:00) and only give details for the days
of the week when you intend the premises
to be used for the activity.

TUESDAY

Start 08:00

End 03:30

Start

End

WEDNESDAY

Start 08:00

End 03:30

Start

End

THURSDAY

Start 08:00

End 03:30

Start

End

FRIDAY

Start 08:00

End 03:30

Start

End

SATURDAY

Start 08:00

End 03:30

Start

End

SUNDAY

Start 08:00

End 03:30

Start

End

State any seasonal variations

For example (but not exclusively) where the activity will occur on additional days during the summer months.

One additional hour to standard timings on the day that British Summer Time Commences

Non standard timings. Where you intend to use the premises to be open to the members and guests at different times from those listed in the column on the left, list below

For example (but not exclusively), where you wish the activity to go on longer on a particular day e.g. Christmas Eve.

Continued from previous page...

Section 18 of 21

LICENSING OBJECTIVES

Describe the steps you intend to take to promote the four licensing objectives:

a) General – all four licensing objectives (b,c,d,e)

List here steps you will take to promote all four licensing objectives together.

CCTV equipment must be installed on the premises and will be maintained in good working order in accordance with the manufacturer's instructions. Training should be provided for staff members in the usage of the CCTV equipment. CCTV footage recorded must, as a minimum, cover each entry/exit point of the premises and be recording at all times when the premises is conducting licensable activities.

The images recorded by the CCTV system shall be retained in unedited form for a period of not less than 30 days.

The Data Controller will make footage available within a reasonable time to a Police Constable or Authorised Officer, where such request is made in accordance with and which satisfies the Data Protection Act 1998.

The premise is a takeaway and not an off-licence. Alcohol will be ancillary to a takeaway delivery only and not on sale or display in the shop for general purchase.

Challenge 25 will be in operation at the premises as per (e).

b) The prevention of crime and disorder

CCTV equipment must be installed on the premises and will be maintained in good working order in accordance with the manufacturer's instructions. Training should be provided for staff members in the usage of the CCTV equipment. CCTV footage recorded must, as a minimum, cover each entry/exit point of the premises and be recording at all times when the premises is conducting licensable activities.

The images recorded by the CCTV system shall be retained in unedited form for a period of not less than 30 days.

The Data Controller will make footage available within a reasonable time to a Police Constable or Authorised Officer, where such request is made in accordance with and which satisfies the Data Protection Act 1998.

c) Public safety

The premises will comply with the Regulatory Reform Fire Safety Order 2005

d) The prevention of public nuisance

The premises will not have an adverse effect on the public in terms of nuisance. The premises is located in a retail area amongst other retail/food premises.

Staff will regularly monitor the external area of the premises and ensure that it is free from litter.

Continued from previous page...

e) The protection of children from harm

A documented Challenge 25 scheme will be operated at the premises. The Challenge 25 scheme shall be actively promoted and advertised at the premises and will ensure that any person purchasing alcohol, who appears to be under 25 years of age, shall be asked to provide acceptable identification to prove that they are 18 years of age or over. Failure to supply such identification will result in no sale or supply of alcohol to that person.

The Proof of Age Standards Scheme (PASS) will be actively promoted.

A PASS accredited holographic proof of age card will be the main identification document accepted at the premises as proof of age. A PASS card must be accepted as proof of age if a purchaser possesses one. Where a purchaser does not possess a PASS accredited proof of age card, only the following alternative forms of alternative identification will be acceptable:-

- (a) Photo driving licence
- (b) Passport or
- (c) Her Majesty's Forces Warrant Card

To utilise and fully record any refused sales or challenges made to patrons and such records be kept in an appropriate form and be made available on inspection to the police or other authorised agency.

All staff involved with the provision of alcohol will successfully complete training in age related products prior to supplying an order. Refresher training will also be successfully completed not more than every 6 months, this will be fully documented and be available for inspection to police officers or other authorised persons.

Section 19 of 21

NOTES ON DEMONSTRATING ENTITLEMENT TO WORK IN THE UK

Continued from previous page...

Capacity 80000-89999 £56,000.00
Capacity 90000 and over £64,000.00

* Fee amount (£)

DECLARATION

* I/we understand it is an offence, liable on conviction to a fine up to level 5 on the standard scale, under section 158 of the licensing act 2003, to make a false statement in or in connection with this application.

Ticking this box indicates you have read and understood the above declaration

This section should be completed by the applicant, unless you answered "Yes" to the question "Are you an agent acting on behalf of the applicant?"

* Full name

* Capacity

* Date / /
dd mm yyyy

Once you're finished you need to do the following:

1. Save this form to your computer by clicking file/save as...
2. Go back to <https://www.gov.uk/apply-for-a-licence/premises-licence/lancaster/apply-1> to upload this file and continue with your application.

Don't forget to make sure you have all your supporting documentation to hand.

IT IS AN OFFENCE LIABLE TO SUMMARY CONVICTION TO A FINE OF ANY AMOUNT UNDER SECTION 158 OF THE LICENSING ACT 2003, TO MAKE A FALSE STATEMENT IN OR IN CONNECTION WITH THIS APPLICATION

IT IS AN OFFENCE UNDER SECTION 24B OF THE IMMIGRATION ACT 1971 FOR A PERSON TO WORK WHEN THEY KNOW, OR HAVE REASONABLE CAUSE TO BELIEVE, THAT THEY ARE DISQUALIFIED FROM DOING SO BY REASON OF THEIR IMMIGRATION STATUS. THOSE WHO EMPLOY AN ADULT WITHOUT LEAVE OR WHO IS SUBJECT TO CONDITIONS AS TO EMPLOYMENT WILL BE LIABLE TO A CIVIL PENALTY UNDER SECTION 15 OF THE IMMIGRATION, ASYLUM AND NATIONALITY ACT 2006 AND PURSUANT TO SECTION 21 OF THE SAME ACT, WILL BE COMMITTING AN OFFENCE WHERE THEY DO SO IN THE KNOWLEDGE, OR WITH REASONABLE CAUSE TO BELIEVE, THAT THE EMPLOYEE IS DISQUALIFIED

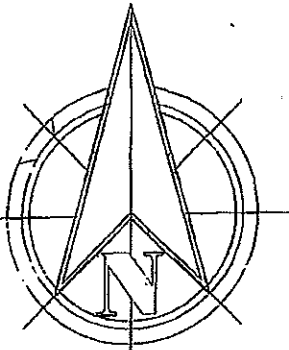

metres 1 2 3 4 5

NORTH ROAD

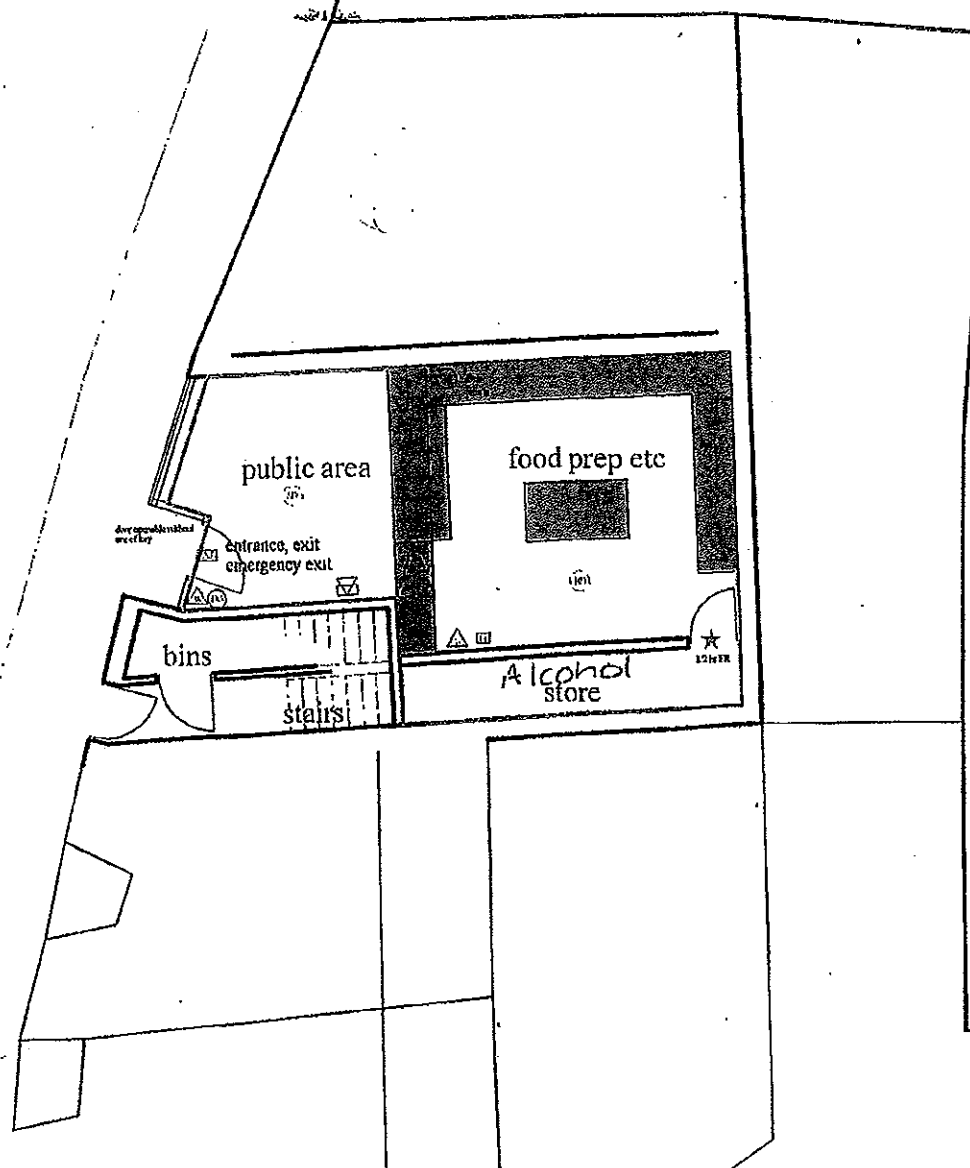

CCG Architects
75 Ormskirk Business Park
New Court Way
Ormskirk
Lancs L39 2YT
P 01695 577701
E Mail mail@ccgarchitects.com
www.ccgarchitects.com

Licensing Drawing
Change of Use of
Shop to Fast Food Outlet
71 North Road
Lancaster

scale	1:100@A4
date	11/18
drawing	2501/lic/A4